

## TYPE 38 GUIDE

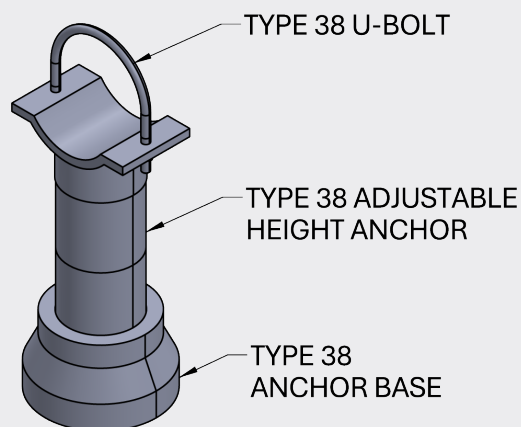

### OVERVIEW

<b>Size Range:</b>	2" - 10" NPS
<b>Material*:</b>	Carbon Steel, Stainless Steel 304
<b>Service</b>	For use in functional vacuum insulated piping
<b>Specifications</b>	MSS-SP-58, MSS-SP-69
<b>Ordering Information</b>	sales@cranecryogenics.com rvargas@cryoworks.net

\*Teflon, pvc, or stainless pads or coatings are available for CS supports to prevent galvanic corrosion of the stainless jacket pipe.

### SPECIFICATIONS

#### Features:

- Fixed Height
- Higher Allowable Loads
- Designed in accordance with MSS-SP-58
- Used to limit deflection in radial directions while allowing axial movement

#### Allowable Temperatures:

- -20°F Minimum Allowable Temperature Carbon Steel.
- -320°F Stainless Steel (will hold strength if supports get cold)
- 120°F Maximum Allowable Temperature
- Note VIP supports are to be used in 'ambient conditions'.

#### General Notes:

- Guide loads are listed in accordance with MSS-SP-58. It is the responsibility of the end user to ensure that the total load is suited for the guide and associated field steel.

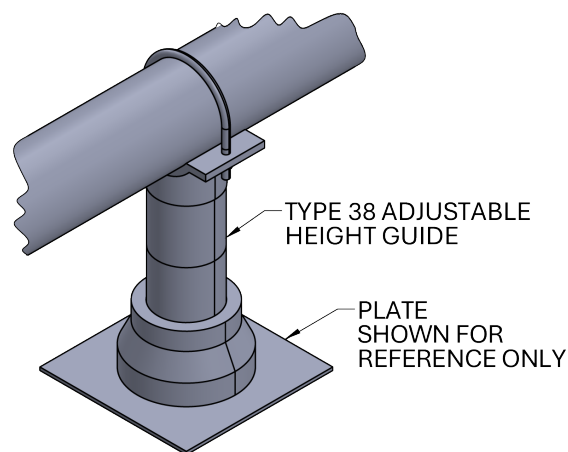

## TYPE 38 GUIDE

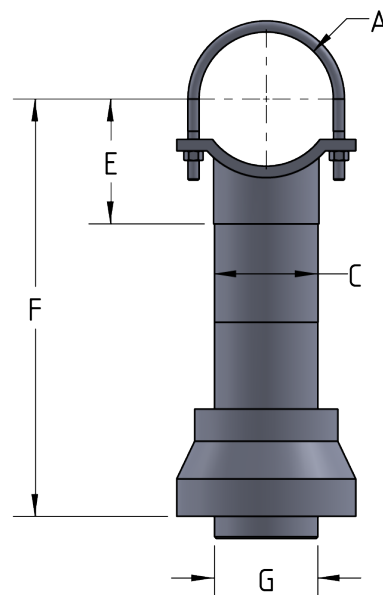
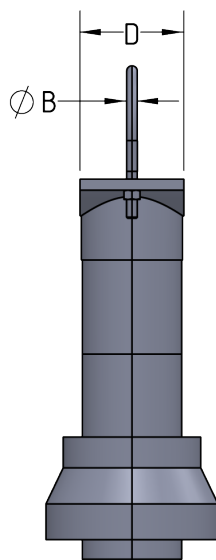

PIPE SIZE (NPS)	U-BOLT		ADJUSTABLE HEIGHT GUIDE					G (MIN CLEARANCE)	H
	A (RADIUS)	B (DIAMETER)	C	D	E	F			
						(MIN)	(MAX)		
4"	2 1/4"	3/8"	3"	3 5/8"	4 3/16"	9 1/2"	14"	4"	1/8"
5"	2 3/4"	1/2"			4 13/16"	10 1/8"	14 5/8"		
6"	3 5/16"				5 7/16"	10 3/4"	15 1/4"		
8"	4 5/16"				3/4"	6 15/16"	12 1/4"		
10"	5 3/8"	8 7/16"				13 3/4"	18 1/4"		
12"	6 3/8"	9 15/16"				14 5/8"	19 1/8"		
16"	8"	7/8"		6"	11 1/2"	16 13/16"	21 5/16"		

PIPE SIZE (NPS)	SUPPORT LOADS (-Y ONLY)	GUIDE LOADS
4"	2500	250
5"	1200	350
6"	2900	500
8"	2900	500
10"	1950	550
12"	2350	600
16"		

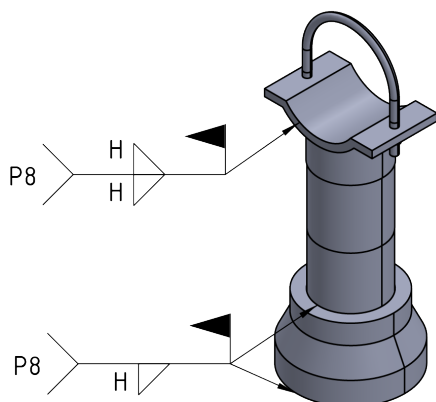

**NOTES:**

1. FIELD WELD PROCEDURES BY OTHER.
2. FIELD WELDS TO BE PERFORMED TO IAW ASME BPVC SECTION IX.