

## TYPE 24 REST

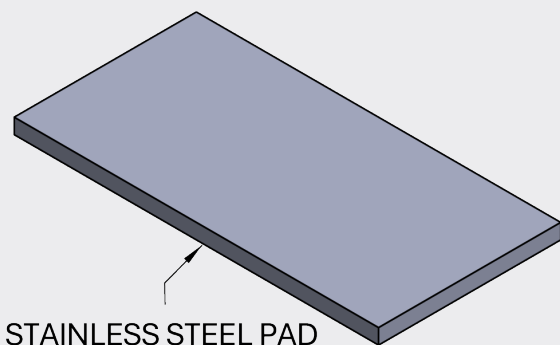

### OVERVIEW

<b>Size Range:</b>	2" - 10" NPS
<b>Material*:</b>	Carbon Steel, Stainless Steel 304
<b>Service</b>	For use in functional vacuum insulated piping
<b>Specifications</b>	MSS-SP-58, MSS-SP-69
<b>Ordering Information</b>	sales@cranecryogenics.com rvargas@cryoworks.net

\*Teflon, pvc, or stainless pads or coatings are available for CS supports to prevent galvanic corrosion of the stainless jacket pipe.

### SPECIFICATIONS

#### Features:

- Fixed Height
- Higher Allowable Loads
- Designed in accordance with MSS-SP-58
- Used to support the weight of the pipe

#### Allowable Temperatures:

- -20°F Minimum Allowable Temperature Carbon Steel.
- -320°F Stainless Steel (will hold strength if supports get cold)
- 120°F Maximum Allowable Temperature
- Note VIP supports are to be used in 'ambient conditions'.

#### General Notes:

- The allowable load of the rest is driven by the field steel.
- Teflon and PVC pads accept the load rating of the field steel.

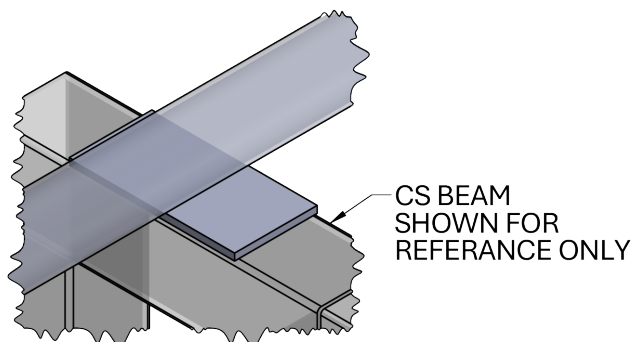

## TYPE 24 REST

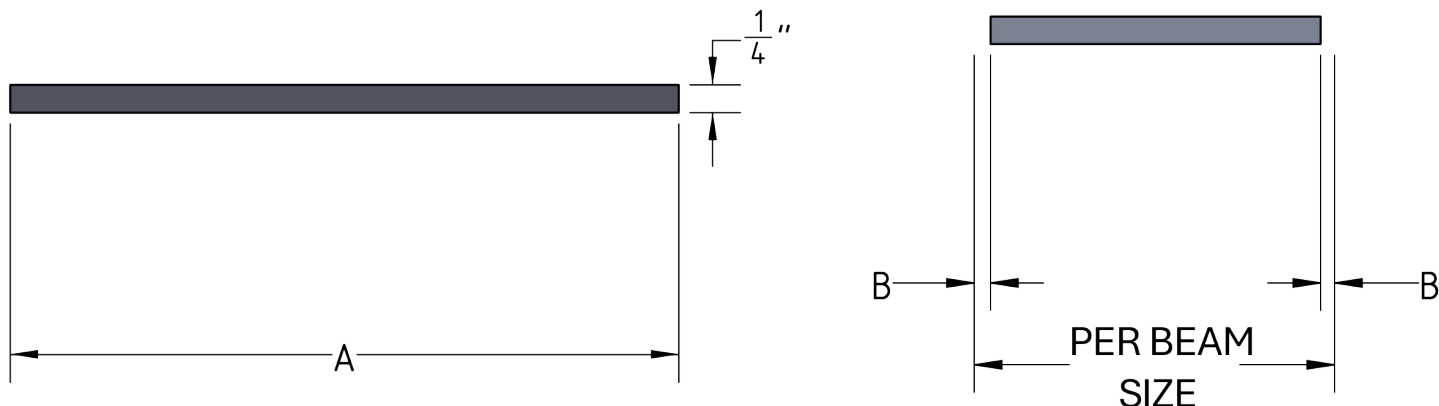

PIPE SIZE (NPS)	STAINLESS STEEL PAD		WELD	SUPPORT LOADS (-Y ONLY)
	A	B	F	
2"	6"	1/8"	1/8"	1000
3"	7"			1750
4"	8"			2450
5"	9"			2600
6"	10"			2950
8"	12"		3/16"	2800
10"	14"			3300
12"	16"			
16"	19"			

### NOTES:

1. FIELD WELD PROCEDURES BY OTHER.
2. FIELD WELDS TO BE PERFORMED TO IAW ASME BPVC SECTION IX.

